

NO DIMENSIONS TO BE SCALED FROM THIS DRAWING

This drawing is issued for the sole and exclusive use of the named recipient. Distribution to any third party is on the strict understanding that no liability is accepted by Pick Everard for any discrepancies, errors or omissions that may be present, and no guarantee is offered as to the accuracy of information shown

CDM - RESIDUAL RISKS  
There are considered to be no significant risks relevant to this drawing.

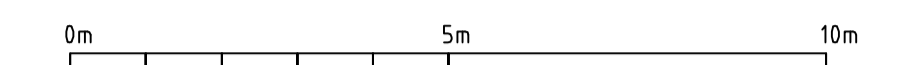

KEY:  
- - - - - LINE INDICATING EXTENT OF NEW GYM

NOTES:  
Refer to drg. 011 for scope of works.

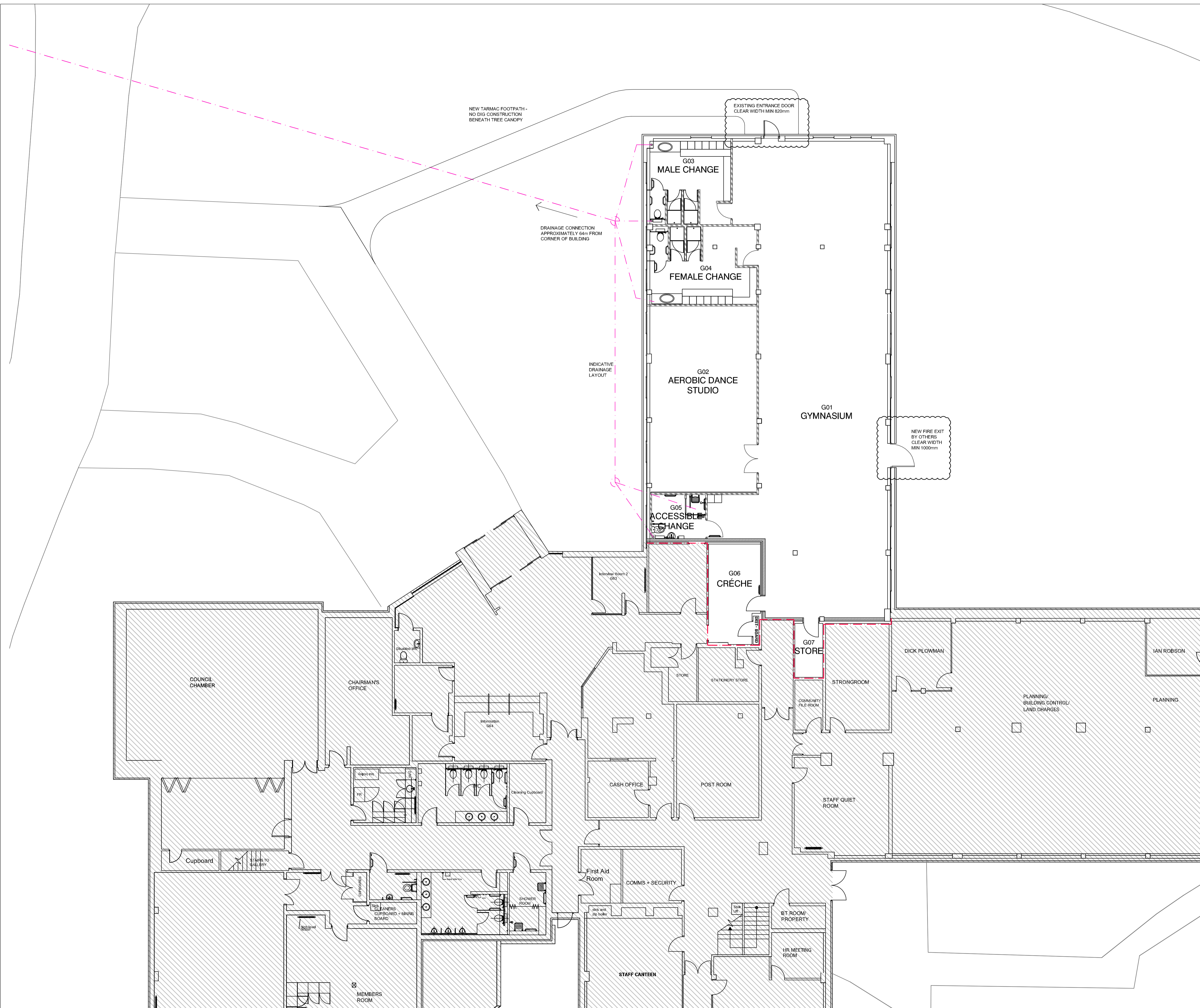

Revisions	Date	Drawn	Chk'd
P06 Fire exit moved, notes added to external doors	09.01.15	IC	KP
P05 Minor client amendments for tender	20.10.14	IC	KP
P04 Additional notes added for tender	01.10.14	IC	KP
P03 Fire exit added and minor client layout changes	18.09.14	IC	KP
P02 Layout revised from Client email 03.09.14	04.09.14	IC	KP
P01 First issue	19.08.14	BMR	IC

CLIENT  
**Anglia Community Leisure & Abbeycroft Leisure**

Architects  
Consulting Engineers  
Project Managers  
Surveyors

**PICK EVERARD**  
Weaver House  
9 Looms Lane  
Bury St Edmunds  
Suffolk  
IP33 1HE  
Phone 01284 760331  
Fax 01284 761433  
buryoffice@pickeverard.co.uk  
www.pickeverard.co.uk

PROJECT  
Pop-up Gym  
Forest Heath DC  
Mildenhall

DRAWING TITLE Proposed Building Layout	PICK EVERARD PROJECT No. <b>140796</b> SCALE - unless otherwise stated 1:100 at A1
DRAWING NUMBER <b>000-PE-XX-ZZ-DR-A-0012</b>	STATUS PURPOSE OF ISSUE TENDER REV <b>P06</b>